

825-07-002-KIT  
2018 Transfer, Internal, Die-Cast Bottom Cap Assy

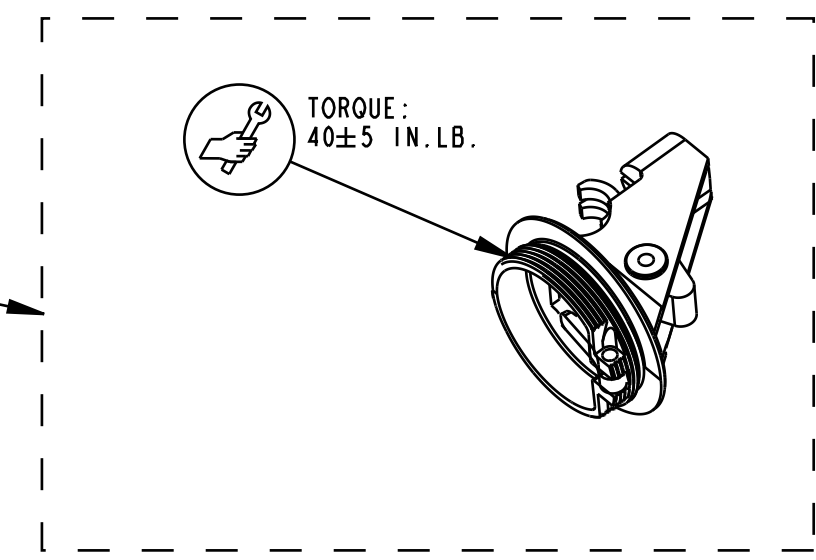

225-00-052  
Bushing, Cable, Seat Post

038-00-132  
Retaining Ring: Internal Wire Ring, 27MM X 1.2MM C/S  
Seals: O-Ring [(-025) .070 C.S. X 1.176 ID] Standard, N-70, Static

LOWER POST

FRONT OF POST

BACK OF POST

SECTION A-A

IMPORTANT: BACK OF LOWER POST ORIENTED TO THIS SIDE  
IMPORTANT: ORIENTATION OF BOTTOM CAP

SECTION B-B

GREASE:  
THIN LAYER  
OF SLICK HONEY

INDEX PIN

UPPER POST

TORQUE:  
80±5 IN. LB.

TORQUE:  
45 IN. LB.

803-01-563  
Kit: 2021 Transfer Saddle Clamp Hardware: Bolt & Barrel Nut, Pair

225-00-226  
2021 Transfer, Saddle Clamp, Lower

803-01-563  
Kit: 2021 Transfer Saddle Clamp Hardware: Bolt & Barrel Nut, Pair

UPPER CLAMPS:  
225-00-468: 2021 Transfer, Saddle Clamp, Upper, CI  
225-00-329: 2021 Transfer, Saddle Clamp, Upper, 9mm Oval Rails

PROPRIETARY - THIS DOCUMENT CONTAINS CONFIDENTIAL, PROPRIETARY INFORMATION THAT IS FOR PROPERTY. DO NOT DISCLOSE TO OR DUPLICATE FOR OTHERS EXCEPT AS AUTHORIZED BY FOX.

**FOX** FOX Factory, Inc. Ph 831-768-1100  
130 Hangar Way, Watsonville, CA 95076 USA Fax 831-768-9312

TITLE  
**2021 TRANSFER SEATPOST**

SIZE DWG. NO.  
D  
PLOT SCALE 1:1 SHEET 1 OF 1